

**Drain:** CASTETTER AND RANDALL      **Drain #:** 154  
**Improvement/Arm:** SUNBLEST FARMS SEC. 17D  
**Operator:** J. LIVINGSTON      **Date:** 11-13-03  
**Drain Classification:** Urban/Rural      **Year Installed:** 1986

### GIS Drain Input Checklist

- Pull Source Documents for Scanning JLJ
- Digitize & Attribute Tile Drains n/a
- Digitize & Attribute Storm Drains JLJ
- Digitize & Attribute SSD n/a
- Digitize & Attribute Open Ditch n/a
- Stamp Plans JLJ
- Sum drain lengths & Validate JLJ
- Enter Improvements into Posse JLJ
- Enter Drain Age into Posse n/a
- Sum drain length for Watershed in Posse n/a
- Check Database entries for errors JLJ

Gasb 34 Footages for Historical Cost  
Drain Length Log

Drain-Improvement: CASSETER & RANDALL - SUNBLEST FARMS SEC. 17 D

Drain Type:	Size:	Length ( )	Length (DB Query)	Length Reconcile	If Applicable	
					Price:	Cost:
RCP	36"	65'	99'	34	32.25/lf	3192.75

Sum: 65'   99'   34'   3192.75

Final Report: 65'

Comments:  
ASBUILTS DO NOT MATCH FINAL REPORT. MAP CHANGE SHOULD  
BE WRITTEN.

---



---



---



---

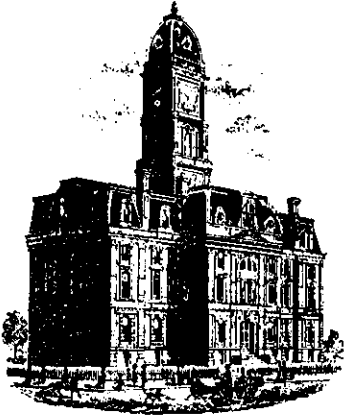

SURVEYOR'S OFFICE  
**Hamilton County**

*Kenton C. Ward, Surveyor*

*Phone (317) 776-8495*

*Fax (317) 776-9628*

*Suite 146*

*One Hamilton County Square*

*Noblesville, Indiana 46060-2230*

August 21, 1995

To: Hamilton County Drainage Board

Re: Castetter-Randall Legal Drain  
Sunblest Farms Sec. 17-D

Attached are as-builts, certificate of completion & compliance, and other information for Sunblest Farms Sec. 17D. An inspection of the drainage facilities for this section has been made and the facilities were found to be complete and acceptable. This was done under my report to the Board dated April 15, 1986.

The drain consists of the following:

36" RCP - 65 feet

\*Note the original tile runs through the dry detention area and parallel to the open ditch. This tile was restored per work order 92-176 and a catch basin was placed at the southwest corner of lot 149 of Sunblest Farms 17-D in the open ditch.

There was no net gain or loss due to the construction of this subdivision section.

I recommend the Board approve the drains construction as complete and acceptable.

---

Kenton C. Ward,  
Hamilton Co. Surveyor

KCW/nw

Could not find original. Retyped 05/10/96 to place copy in  
Surveyors Annual Report for May 28th meeting.

HOLEY MOLEY SAYS,  
**"DON'T DIG BLIND"**



1-800-382-5544  
 CALL TOLL FREE  
 1-800-428-5200  
 FOR CALLS OUTSIDE OF INDIANA

ASSUMED NORTH  
 SCALE: 1" = 50'

- GENERAL NOTES:**
- ALL GRADES AT BOUNDARY SHALL MEET EXISTING GRADES.
  - IT SHALL BE THE RESPONSIBILITY OF EACH SUBCONTRACTOR TO VERIFY ALL EXISTING UTILITIES AND CONDITIONS PERTAINING TO HIS PHASE OF WORK. IT SHALL ALSO BE THE SUBCONTRACTOR'S RESPONSIBILITY TO CONTACT THE OWNERS OF THE VARIOUS UTILITIES FOR PROPER STAKE LOCATION OF EACH UTILITY BEFORE WORK IS STARTED. THE SUBCONTRACTOR SHALL NOTIFY IN WRITING THE OWNER OR THE ENGINEER OF ANY CHANGES, OMISSIONS, OR ERRORS FOUND ON THESE PLANS OR IN FIELD BEFORE WORK IS STARTED OR RESUMED.
  - STANDARD SPECIFICATIONS FOR THE TOWN OF FISHERS, INDIANA SHALL APPLY FOR ALL SANITARY SEWERS AND STORM SEWERS.
  - ANY PART OF THE SANITARY OR STORM SEWER TRENCHES RUNNING UNDER PAVED AREAS TO BE BACKFILLED WITH GRANULAR MATERIAL.
  - THE SIZE AND LOCATION OF EXISTING UTILITIES SHOWN ARE PER INFORMATION PROVIDED BY THE RESPECTIVE UTILITY COMPANIES. ALL UTILITY COMPANIES SHOULD BE NOTIFIED PRIOR TO ANY EXCAVATION FOR FIELD LOCATION OF SERVICES.
  - SERVICE WALKS SHALL BE NON-REINFORCED CONCRETE 4" THICK AND 4' IN WIDTH.
  - EXPANSION JOINTS ARE TO BE PLACED AT ALL WALK INTERSECTIONS AND BETWEEN WALKS AND PLATFORMS. SIDEWALK SCORES ARE TO BE EQUALLY SPACED BETWEEN EXPANSION JOINTS. CONTRACTION JOINTS AND PERPENDICULAR SIDEWALKS AT 5' INTERVALS OR LESS WITH A CONTRACTION JOINT EVERY 20' OR LESS.
  - 4" CONCRETE SERVICE WALK ACROSS FRONTAGE OF EACH LOT TO BE CONSTRUCTED BY OTHERS.
  - TEMPORARY TRAFFIC CONTROL DURING CONSTRUCTION TO CONFORM TO APPLICABLE LOCAL AND STATE STANDARDS.
  - ALL CONSTRUCTION ACTIVITY ON THIS SITE TO BE PERFORMED IN COMPLIANCE WITH APPLICABLE O.S.H.A. STANDARDS FOR WORKER SAFETY.
  - CONTRACTOR SHALL MINIMIZE DAMAGE TO EXISTING TREES.

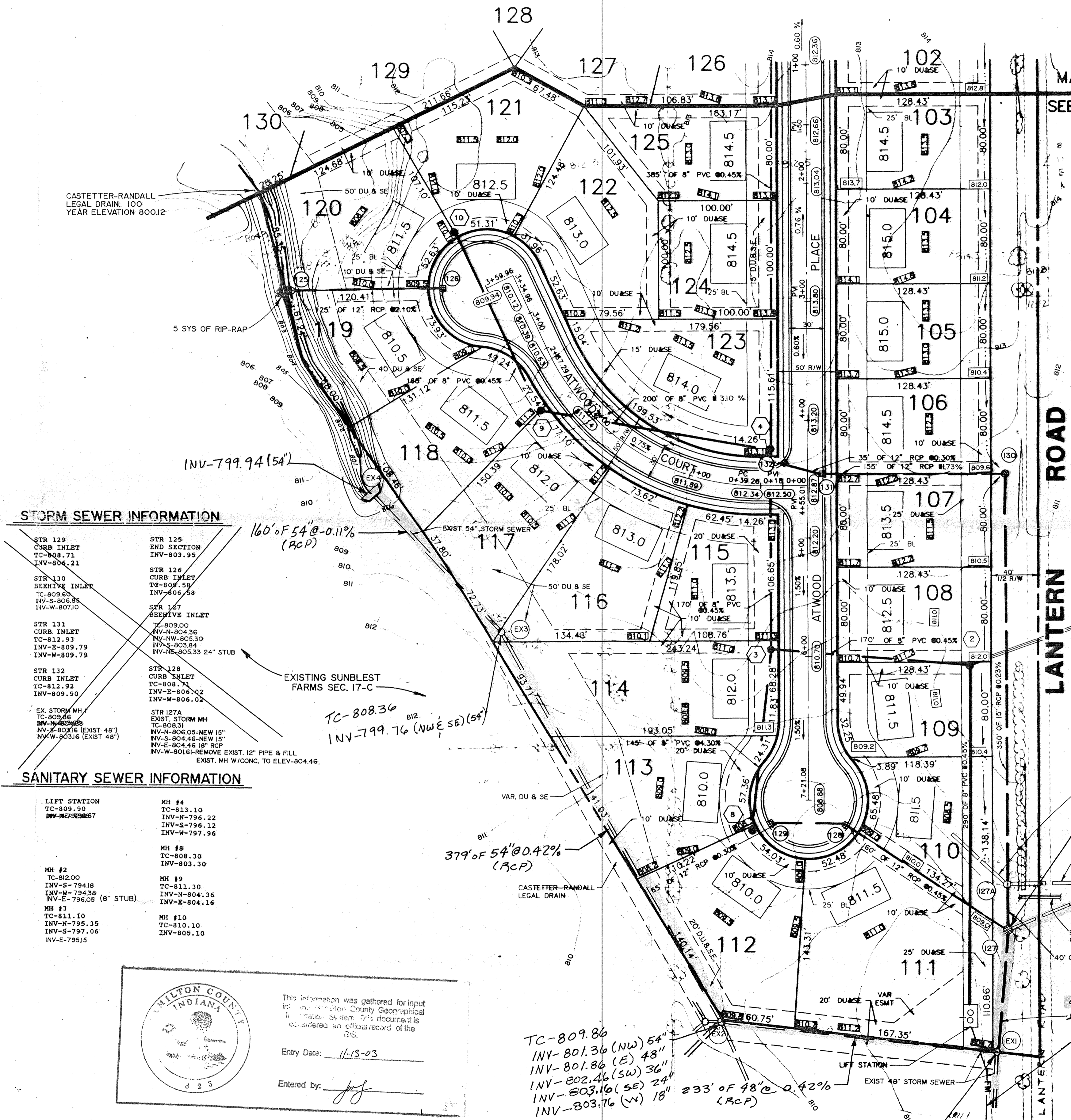

MATCH LINE  
 SEE SHEET S-5

- BENCH MARKS:**
- TBM 14: NORTHEAST HEX NUT ON FIRE HYDRANT AT THE SOUTHEAST CORNER OF ORCHARD BLVD. ELEVATION-803.212
  - TBM 15: RAILROAD SPIKE ON NORTH SIDE OF POWER POLE # 55-732 ON SOUTH SIDE 126TH STREET (3RD POLE WEST OF LANTERN RD). ELEVATION-824.980
  - TBM 20: RAILROAD SPIKE IN POWER POLE # 35-734 IN THE SOUTHWEST CORNER OF 126TH STREET AND LANTERN ROAD. ELEVATION-813.840
  - TBM 21: BOAT SPIKE IN TELEPHONE POLE ON EAST SIDE OF LANTERN ROAD 20' NORTH OF 6" HIGH YELLOW GAS LINE MARKER, 100' NORTH OF RAILROAD TRACKS. ELEVATION-810.750
  - TBM 22: RAILROAD SPIKE IN POWER POLE # 51-980 ON EAST SIDE OF LANTERN ROAD (5' SOUTH OF EDGE OF PAVEMENT) AND 80' SOUTH OF RAILROAD TRACK #. ELEVATION-824.415

**CERTIFICATION FOR "RECORD DRAWING"**

*Richard G. Raiback*  
 CERTIFIED BY:  
 SCHNEIDER ENGINEERING CORPORATION  
 3020 NORTH POST ROAD  
 INDIANAPOLIS, INDIANA 46226-6518  
 P.O. BOX 28068 (317) 986-5282

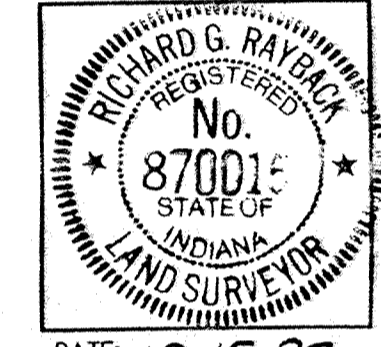

NOTE:  
 Record drawing certification only for top of coating, invert elevations and lengths of pipe. Slope percentage represents a calculated figure and is for general information only.

DATE: 10-15-92

**STORM SEWER INFORMATION**

- STR 129 CURB INLET TC-808.71 INV-804.21
- STR 130 BEEHIVE INLET TC-809.88 INV-806.85
- STR 131 CURB INLET TC-812.93 INV-E-809.79
- STR 132 CURB INLET TC-812.92 INV-809.90
- STR 127 CURB INLET TC-808.71 INV-804.21
- STR 126 CURB INLET TC-808.58 INV-806.58
- STR 127 BEEHIVE INLET TC-809.00 INV-N-804.36
- STR 128 CURB INLET TC-808.71 INV-E-806.02
- STR 127A EXIST. STORM MH TC-808.33 INV-N-806.05-NEW 15" INV-S-804.46-NEW 15" INV-E-804.46 18" RCP INV-W-801.61-REMOVE EXIST. 12" PIPE & FILL EXIST. MH W/CONC. TO ELEV-804.46

**SANITARY SEWER INFORMATION**

- LIIFT STATION TC-809.90 INV-W-807.98
- MH #4 TC-813.10 INV-N-796.22 INV-S-796.12 INV-W-797.96
- MH #8 TC-808.30 INV-803.30
- MH #9 TC-811.30 INV-N-804.35 INV-E-804.16
- MH #10 TC-810.10 INV-805.10
- MH #11 TC-811.10 INV-N-795.35 INV-S-797.06 INV-E-795.15

**UTILITIES**

- Gas:** Citizens Gas & Coke Utility, 15900 Allisonville Road, Noblesville, Indiana 46060 (317) 773-0430
- Water:** Indianapolis Water Company, 1220 Waterway Boulevard, Indianapolis, Indiana 46206 (317) 283-6319
- Telephone:** Indiana Bell Telephone Co., 220 North Meridian Street, Indianapolis, Indiana 46220 (317) 265-5878 or 1-800-382-5544 (317) 849-5260
- Cable Television:** Insight Communications Co., 694 Logan Street, Noblesville, Indiana 46060 (317) 776-0660
- Electric:** Public Service Indiana, 100 Mill Creek Road, Noblesville, Indiana 46060 (317) 773-1980
- Sanitary Sewer:** Town of Fishers, 8597 E. 116th Street, Fishers, Indiana 46038 (317) 849-6260
- Storm Sewer:** Town of Fishers, 8597 E. 116th Street, Fishers, Indiana 46038 (317) 849-6260



This information was gathered for input into the Hamilton County Geographical Information System. This document is considered an official record of the GIS.

Entry Date: 11-13-03

Entered by: *[Signature]*

**LEGEND**

- Existing Storm Sewer
- New Storm Sewer
- Existing Sanitary Sewer
- New Sanitary Sewer
- Existing Contour
- Existing Elevation
- Storm Structure Number
- Sanitary Structure Number
- Flow Arrow

**STORM SEWER RECORD DRAWING**

PROJECT: SUNBLEST FARMS, SECT. 17D 388.20  
 PREPARED FOR: K.E. THOMPSON CO., INC.  
 TITLE: STORM SEWER RECORD DRAWING  
 SHEET 9 OF 6  
 DATE: 10-15-92

NOTE  
 The size and location of utilities are per plans and locations provided by the respective utility companies. All utility companies shall be notified prior to any excavation for field location of services.